

# Low Flow Hydro-Pro 150® Spray Nozzle

## Heavyweight performance in a lightweight design!

Just as with the standard Hydro-Pro 150® Spray Nozzle, the Hydro-Pro Low Flow Spray Nozzle shares the same great features, namely a stainless steel housing providing strength, durability and light weight and a light weight of less than 2 lbs.! An ergonomic design results in a reduction in user fatigue. The Hydro-Pro 150® also features a patented, locking trigger mechanism providing the user a means to lock in a desired spray pattern without maintaining trigger pressure. In addition, the locking trigger helps reduce misdirected spraying.

Along with these features, when you purchase a Hydro-Pro 150® Low Flow nozzle, you will quickly see a reduction in water consumption and the savings that are sure to go along with it.



**Shown:** Black Hydro-Pro 150

**Shown Below:** White and Red Hydro-Pro 150

## Specifications

- ♦ Maximum working pressure ..... 150 psi
- ♦ Maximum recommended operating pressure ..... 200°F/93°C
- ♦ Available: black, white or red cover
- ♦ Available with or without swivel adapter

**NOTE:** Intended for water use only.  
Not suitable for steam service.

*Please see reverse side for parts listing and flow rates.*



**USA Headquarters**

2801 Baglyos Circle ♦ Bethlehem, PA 18020

Phone: (484) 893-5080 ♦ Fax: (484) 893-5099 ♦ Toll Free: (877) STRAHMAN

[www.strahmanvalves.com](http://www.strahmanvalves.com)

### France

Savoie Hexapole, F-73420 Mery, France

Tel: 33 (0) 4 79 35 78 00

Fax: 33 (0) 4 79 35 78 20

### Germany

Kirchstrasse 16, D-77855, Achern, Germany

Tel: 49 (0) 7841-6846530

Fax: 49 (0) 7841-6846531



ISO 9001  
QMS-SAI Global

Last Updated: July, 2012

# Low Flow Hydro-Pro 150® Spray Nozzle

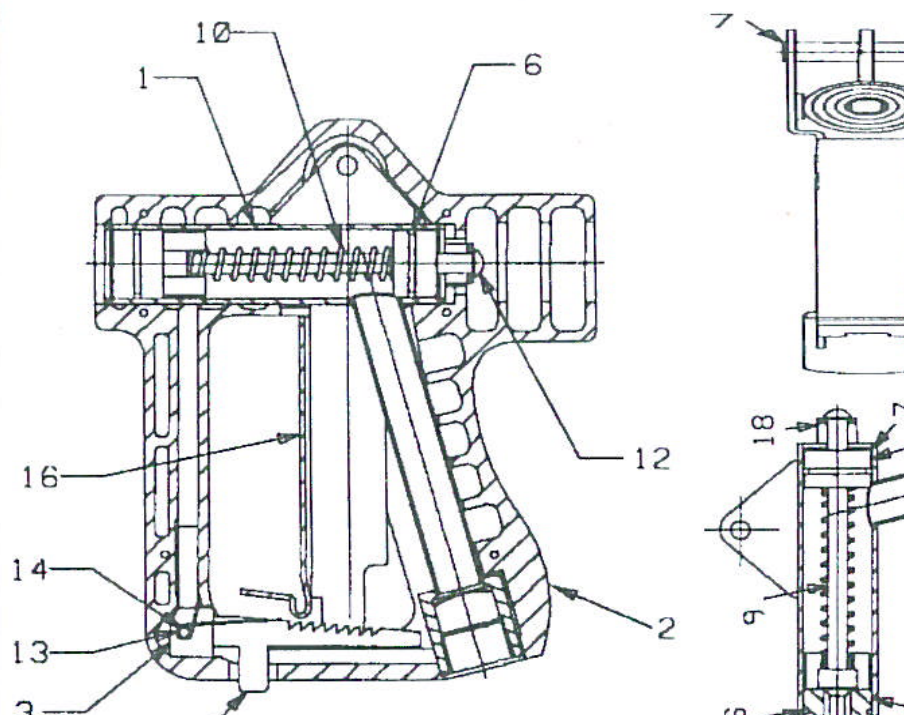

PARTS			
PART NO.	DESCRIPTION	PART NO.	DESCRIPTION
1	HYDRO-PRO® BODY	8	HOUSING
2	BLACK COVER	9	STEM
2	RED COVER	10	STEM SPRING
2	WHITE COVER	12	STEM SCREW and WASHER
3	HINGE	13	RATCHET SPRING
4	COVER SCREWS	14	SPRING PIN
5	RATCHET	15	SEAT
6	O-RINGS	16	LEVER ARM
7	SNAP RING	18	U-BRACKET

HYDRO-PRO-150 FLOW TEST		
	STANDARD	LOW FLOW
PSI	FLOW (gpm)	
20	3 ¼	2 ¼
30	4 ¼	2 ¾
40	5 ⅛	3 ¼
50	5 ⅞	3 ¾
60	6 ¾	4 ⅛
70	7 ½	4 ½
80	7 ¾	4 ⅞
90	8 ¼	5
100	9	5 ⅛