

INSTRUCTION FOR SERVICING SPRAY NOZZLE:

The entire working parts of the **Strahman Mini M-70 Lightweight Spray Nozzle** are contained in a **Single Cartridge Unit**. **CAUTION: Not for use on steam hose.**

To replace cartridge:

1. Remove the **Rubber Cover (20)** by slipping it off the back of the nozzle and pulling it over the front using a round tool: not a sharp tool that can cut cover.
2. Remove the **Lever Arm Screw & Nut (24)** and the **Lever Arm (6)**.
3. **Unscrew Lock Screw (30)** and extract the cartridge from back end of nozzle with **Cage (18)**.
4. Be sure when replacing **Cage (18)** to place cut-away part of cage facing downward, so **Lever Arm (6)** can be inserted.
5. To insert new cartridge, reverse procedure beginning.
6. Be sure **Lever Arm (6)** is placed ahead of **Stem Guide (31)** on cartridge unit.
7. To replace **Rubber Cover (20)** wipe body with detergent, insert nozzle end first then handle into cover. Use a round ended tool approx. 3/8" in diameter to stretch cover over back. Do not use sharp tool. Sharp tools can cut cover.



© STRAHMAN GROUP PUBLISHED 06.21.23

STRAHMANGROUP.COM

WORLD HEADQUARTERS
2801 BAGLYS CIRCLE
BETHLEHEM, PA 18020
P: +1 484.893.5080

E: STRAHMAN@STRAHMAN.COM



MINI M-70 SERIES

Assembly Instructions for Series—
MINI M-70 | MINI M-75 | MINI S-70 | MINI S-75



STRAHMAN
GROUP

PRECISION AND PERFORMANCE



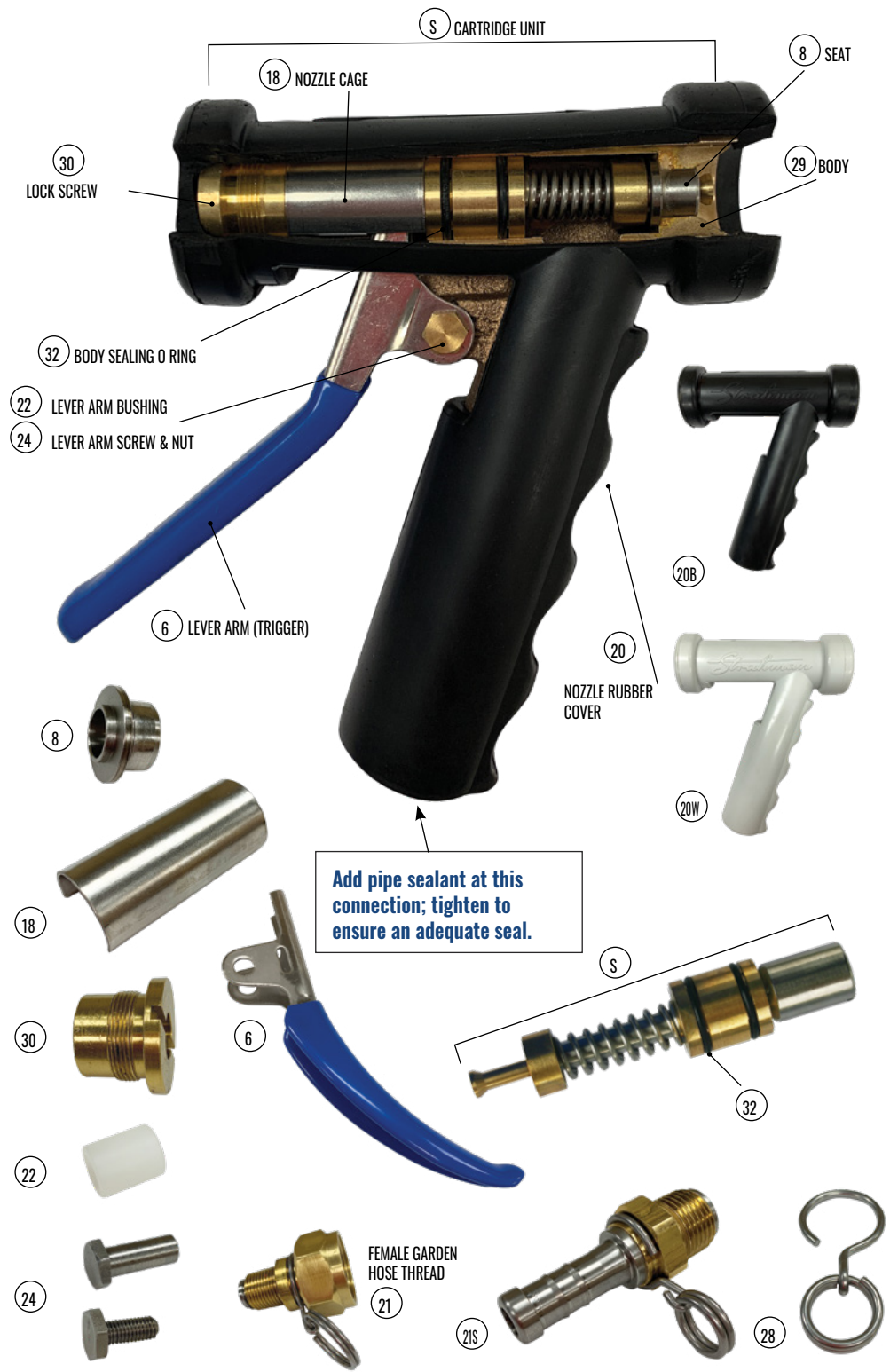

PARTS LIST						
ITEM NO.	ORDER NUMBER	DESCRIPTION	MINI M-70	MINI M-75	MINI S-70	MINI S-75
8	M7MSEAT	SEAT, SS 303	✓	✓	✓	✓
18	M7MCAGE	MINI NOZZLE CAGE, SS 304	✓	✓	✓	✓
30	M7MSCAP	LOCK SCREW, BR C3600	✓	✓		
	M7MSCAPSS	LOCK SCREW, SST			✓	✓
22	M7MBU	MINI LEVER ARM BUSHING NYLON	✓	✓	✓	✓
24	M7MLSCRSS	MINI LEVER ARM SCREW, SS 303			✓	✓
	M7MLSCR	MINI LEVER ARM SCREW, BRONZE	✓	✓		
	M7MLNUT	MINI LEVER ARM NUT, SS 303	✓	✓	✓	✓
6	M7MLARMC	LEVER ARM - BLUE (BL)	✓	✓	✓	✓
29	M7MBDF	BODY, BRASS C83600	✓	✓		
	M7MBDSS	BODY, STAINLESS STEEL 304			✓	✓
20	M7MCOVRBLACK	NOZZLE RUBBER COVER - BLACK (B)	✓	✓	✓	✓
	M7MCOVRWHITE	NOZZLE RUBBER COVER - BLACK (W)	✓	✓	✓	✓
ADAPTER PARTS						
21	MINISWL0075GSS	3/4" MINI GHT SWIVEL HOSE ADAPTER, SST			✓	✓
21S	MINISWL0500SS	1/2" MINI SWIVEL ADAPTER, SST			✓	✓
	MINISWL0063SS	5/8" MINI SWIVEL ADAPTER, SST			✓	✓
	MINISWL0075SS	3/4" MINI SWIVEL ADAPTER, SST			✓	✓
21	MINISWL0075GBR	3/4" MINI GHT SWIVEL HOSE ADAPTER, BRONZE	✓	✓		
21S	MINISWL0500BR	1/2" MINI SWIVEL ADAPTER, BRONZE	✓	✓		
	MINISWL0063BR	5/8" MINI SWIVEL ADAPTER, BRONZE	✓	✓		
	MINISWL0075BR	3/4" MINI SWIVEL ADAPTER, BRONZE	✓	✓		
28	M7MLRNG	MINI LOCK RING, SS302	✓	✓	✓	✓
	HADAP00380050B	MINI ADAPTER TO STRAHMAN HOSE - BRONZE (NOT SHOWN)	✓	✓		
	HADAP00380050SS	MINI ADAPTER TO STRAHMAN HOSE, SST (NOT SHOWN)			✓	✓
REPLACEABLE CARTRIDGE UNIT						
S	M7MCART	MINI NOZZLE CARTRIDGE, BRASS	✓	✓		
	M7MCARTSS	MINI NOZZLE CARTRIDGE, SST			✓	✓
31	STEM GUIDE (INSTALLED WITH CARTRIDGE) (NOT SHOWN)		✓	✓	✓	✓
32	BODY SEALING O RING (INSTALLED W/CARTRIDGE)		✓	✓	✓	✓