



RENEWABLE COVER - BLACK

RENEWABLE COVER - WHITE

RENEWABLE COVER - RED

# HYDRO-PRO 150® WATER-SAVER SPRAY NOZZLE

## Assembly Instructions

### RENEWABLE COVER REPLACEMENT

If the renewable cover (2) becomes worn or cracked, follow the steps below to replace it.

1. Disassemble the renewable cover (2) by loosening and removing the six cover screws (4) (not shown).
2. Lift the body (1) free of the cover (2). Remove the ratchet assembly hinge (3), ratchet (5), and ratchet spring pin (13).
3. Install the body (1) and ratchet assembly-hinge (3) ratchet (5), ratchet spring (13) and spring pin (14) in the new renewable cover (2). Reinstall the six cover screws (4) (not shown).



© STRAHMAN GROUP PUBLISHED 07.24.23

[STRAHMANGROUP.COM](http://STRAHMANGROUP.COM)

WORLD HEADQUARTERS  
2801 BAGLYOS CIRCLE  
BETHLEHEM, PA 18020  
P: +1 484.893.5080

E: [STRAHMAN@STRAHMAN.COM](mailto:STRAHMAN@STRAHMAN.COM)



**STRAHMAN  
GROUP**

PRECISION AND PERFORMANCE



# HYDRO-PRO 150® WATER SAVER NOZZLE

# HYDRO-PRO 150® WATER SAVER NOZZLE

## INSTRUCTIONS FOR SERVICING SPRAY NOZZLE

If the Hydro-Pro 150 begins to leak from the seat (14) or rear of the body (1) follow the steps below. For best results, order original Strahman parts.

1. Disassemble the renewable cover (2) by loosening and removing the six cover screws (4) (not shown).
2. Lift the body (1) free of the cover (2). Remove the ratchet assembly hinge (3), ratchet (5), and ratchet spring pin (13). Place the body in boiling water for 2-3 minutes to release the Loc-Tite bond on stem screw (11). Remove the stem screw (11) and swivel the U-bracket (17) down or up away from the stem (9).
3. Remove the snap rings (7) from the front and rear of the water saver body (1). Push on the rear of the stem (9) until the seat stem (14) and stem spring (10) are free of the body.
4. Carefully press the housing (8) out of the rear of the water saver body (1). Precautions should be taken to avoid damaging the inside of the water saver body.
5. Install a new "O-ring" (6) on the seat (14). Install a new "O-ring" (6) on the new housing (8).
6. Install seat (14) and snap-ring (7) in the front of the water saver body (1). Install the stem (9) and then stem spring (10) from the rear of the water saver body.
7. Install the housing (8) in the rear of the body and compress the stem spring (10). Install a snap ring (7) in the rear of the water saver body.
8. Swivel the U-bracket (17) back into place over the end of the stem (9). Apply Loc-Tite 271 to the stem screw (12) and reinstall.
9. Re-install the body (1) and ratchet assembly-hinge (3) ratchet (5), and ratchet spring pin (13) in the new renewable cover (2). Reinstall the six cover screws (4) (not shown).

PARTS LIST					
ITEM NO.	ORDER NUMBER	DESCRIPTION	ITEM NO.	ORDER NUMBER	DESCRIPTION
1	HPBODYASSM	HYDRO-PRO 150® BODY	9	HP150STEMASSY	STEM ASSEMBLY
2	WSHP1COVER007	RENEWABLE COVER - BLACK	10	SPRG12339S3SS	STEM SPRING (SET OF 6), SST
	WSHP1COVER008	RENEWABLE COVER - RED	11	MSN8320038LWOZ	STEM SCREW & WASHER (SET OF 6)
	WSHP1COVER009	RENEWABLE COVER - WHITE	12*	SPRG12410S5SS	RATCHET SPRING, SST
3*	HP1HINGESS	RATCHET HINGE, SST	13*	HP1SPINSS	RATCHET SPRING PIN (SET OF 6) SST
4	HP1SCR	COVER SCREWS (SET OF 6) (NOT SHOWN)	14	HP1SEAT	HP 150 SEAT, SST
5	HP150RACHETASSY	RATCHET ASSEMBLY (INCLUDES ITEMS #3, 12, 13)		HP1SEATLFSS	HP 150 LOW FLOW SEAT, SST
6	ORNG18MMO2MMEA	O-RINGS (SET OF 6)	15	HP1LARM	LEVER ARM
7	HP1SNAPRINGSS	SNAP RETAINING RING, SST	16	WSHP1LPIVO000	LEVER ARM PIVOT ASSY
8	HP1HOUSASSY	HOUSING, SST	17	HP1UBRKSS	U-BRACKET, SST

\* IS ALSO A PART OF A COMPLETE ASSEMBLY ITEM #5

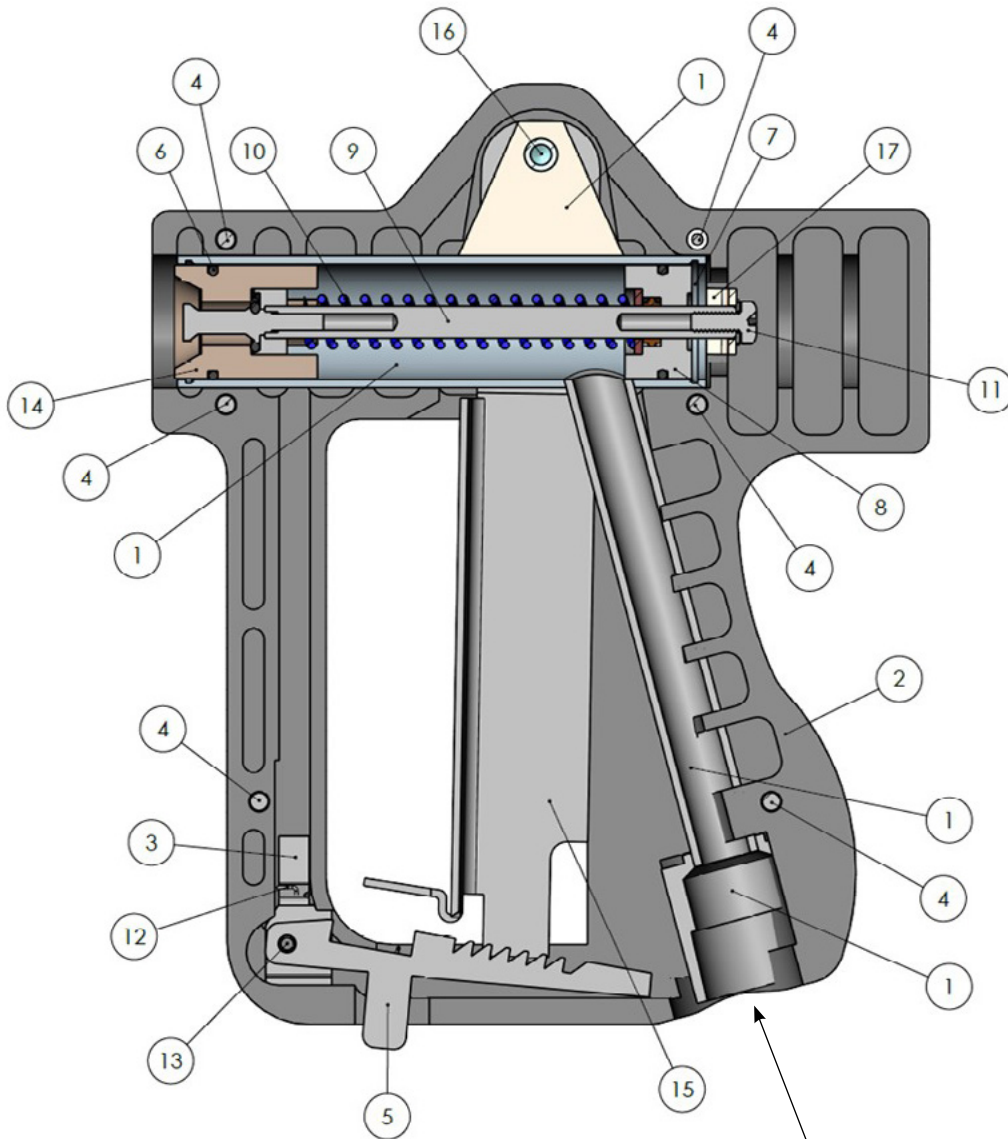

Add pipe sealant at this connection; tighten to ensure an adequate seal.