



M-144TG SERIES

Steam/Cold Water Washdown Station

Instant Hot Water—On Demand.

The M-144TG mixing unit provides instant hot water using a steady supply of steam and cold water. Engineered for performance and safety, the wall mounted design made of durable bronze provides exceptional durability and low maintenance, and reliable temperature control.



Direct Diffuse® Steam Trap quickly and efficiently discharges condensate in your steam line

KEY FEATURES

- **Direct Diffuse® Steam Trap:** Rapidly and efficiently eliminates condensate from steam lines, reducing system wear and failure.
- **Automatic Steam Shut-off:** Activates if cold water pressure drops below 50 psi to prevent dangerous steam discharge.
- **Internal Blending Chamber:** Ensures consistent, accurate temperature mixing.
- **Dial-Type Temperature Gauge:** Displays exact wash water temperature in both °F and °C for optimal safety and control.
- **Premium Materials:** All components are built to ASTM standards, ensuring durability and long-term reliability

SPECIFICATIONS

Optimal Working Pressure	20 psi (1.4 bar) - 80 psi (5.5 bar)
Maximum Design Pressure	150 psi (10.3 bar steam)
Maximum Water Temperature	200° F (93° C)

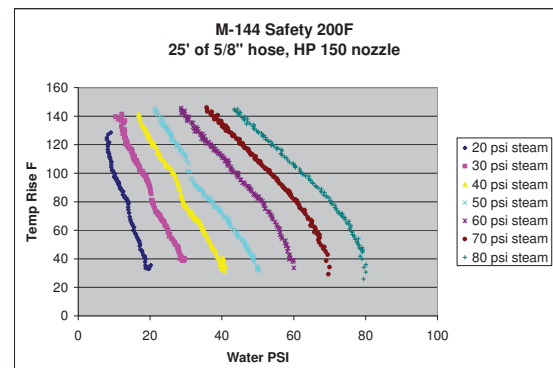
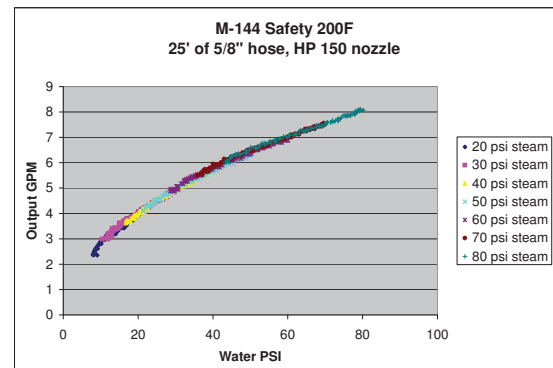

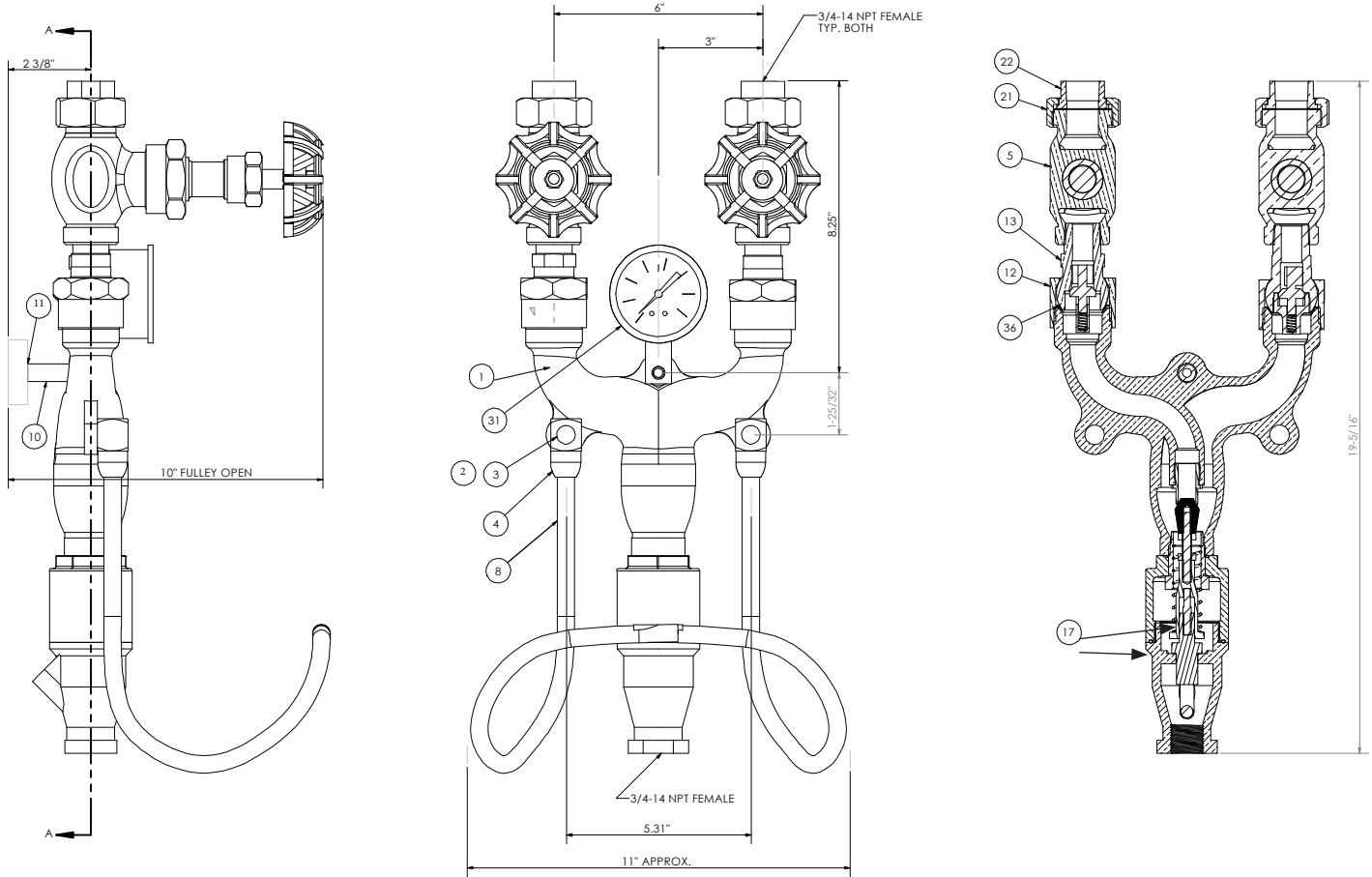
REPLACEMENT PARTS LIST

PART NO.	PRODUCT CODE	DESCRIPTION (MATERIAL)	PART NO.	PRODUCT CODE	DESCRIPTION (MATERIAL)
1	M144BDFB	MAIN BODY (ASTM CA836)	11	MUWPLTBR	WALL PLATE (OPTIONAL) (BRASS B16, CA360)
2	HH0050130200OZ	HOSE RACK CAP SCREW (NOT SHOWN) (SET OF 6) (SST304, ASTM A276)	12	BCNUTBR	BALL CHECK UNION NUT (BRASS ASTM B16 C36000)
3	WAT0050	HOSE RACK LOCK WASHER (NOT SHOWN) (SET OF 6) (SST410)	13	BCBRG	BALL CHECK VALVES COMPLETE (INCLUDES PART 36) (BRASS ASTM B16, C36000, SST303, ASTM A582)
4	HRCONBR	HOSE RACK CONNECTOR (SST304)	17	M144THSTASSY2	THERMOSTAT ASSEMBLY WITH O-RING (SST302)
5	GVBLACKV14UBR	GLOBE VALVE BLACK V-14U (BRASS ASTM B16, C36000, SST303, ASTM A58)	21	GVUTAILBR	UNION TAIL PIECE (BRASS B16)
5	GVREDV14UBR	GLOBE VALVE RED V-14U (BRASS ASTM B16, C36000, SST303, ASTM A58)	22	GVUNUTBR	UNION INLET NUT (BRASS B16)
8	HRCOMPLETE0000	HOSE RACK WITH FITTINGS (SST304, ASTM A276)	31	TGGF02	TEMPERATURE GAUGE (BRASS B283, CA37700)
10	MUSPAC	HEX SPACER (SST416, ASTM A582)	36	BCGAC	BALL CHECK GASKET (COPPER)

*Temperature Gauge: 100-250°F (40-120°C)

NOTE: A STRAINER AND STEAM TRAP IS RECOMMENDED TO BE USED IN CONJUNCTION WITH ALL OUR STEAM MIXING UNITS. FOREIGN DEPOSITS IN SUPPLY LINES CAN EFFECT BALL CHECK DURABILITY. PROPER STEAM AND WATER TREATMENT IS RECOMMENDED TO ENSURE PROPER PERFORMANCE AND DURABILITY. UNIT SHOULD BE SHUT-OFF WHEN NOT IN USE FOR EXTENDED PERIODS OF TIME.

ORDERING INFORMATION & PARTS

THIS BRONZE UNIT INCLUDES A STAINLESS STEEL HOSE RACK AND COMES WITH OUR PATENTED DIRECT DIFFUSE® STEAM TRAP. HOSE AND SPRAY NOZZLE SOLD SEPARATELY. REFER TO THE PARTS LIST FOR MATERIALS AND REPLACEMENT OPTIONS. ALL PARTS ARE BUILT TO LAST, USING ASTM-RATED STAINLESS STEEL, BRASS, AND BRONZE COMPONENTS.